

**Site Inventory Form**  
**State Historical Society of Iowa**  
 (December 1, 1999)

State Inventory No. 70-00170  New  Supplemental  
 Part of a district with known boundaries (enter inventory no.) 70-01005  
 Relationship:  Contributing  Noncontributing  
 Contributes to a potential district with yet unknown boundaries  
 National Register Status: (any that apply)  Listed  De-listed  NHL  DOE  
 Review & Compliance No. \_\_\_\_\_  
 Non-Extant (enter year) \_\_\_\_\_

**1. Name of Property**

historic name Fulliam-Glass House  
 other names/site number Field Site #: WH-002

**2. Location**

street & number 309 West 2<sup>nd</sup> Street  
 city or town Muscatine  vicinity, county Muscatine  
 Legal Description: (If Rural) Township Name \_\_\_\_\_ Township No. \_\_\_\_\_ Range No. \_\_\_\_\_ Section \_\_\_\_\_ Quarter of Quarter \_\_\_\_\_  
 (If Urban) Subdivision Original Town Block(s) 36 Lot(s) 4

**3. State/Federal Agency Certification [Skip this Section]**

**4. National Park Service Certification [Skip this Section]**

**5. Classification**

Category of Property (Check only one box)	Number of Resources within Property		
	If Non-Eligible Property	If Eligible Property, enter number of:	
	Enter number of:	Contributing	Noncontributing
<input checked="" type="checkbox"/> building(s)	_____ buildings	<u>1</u>	_____ buildings
<input type="checkbox"/> district	_____ sites	_____	_____ sites
<input type="checkbox"/> site	_____ structures	_____	_____ structures
<input type="checkbox"/> structure	_____ objects	_____	_____ objects
<input type="checkbox"/> object	_____ Total	<u>1</u>	_____ Total

Name of related project report or multiple property study (Enter "N/A" if the property is not part of a multiple property examination).  
 Title \_\_\_\_\_ Historical Architectural Data Base Number \_\_\_\_\_

A Historical and Architectural Survey of the "West Hill" neighborhood, Muscatine, Iowa 70-016

**6. Function or Use**

<b>Historic Functions</b> (Enter categories from instructions)	<b>Current Functions</b> (Enter categories from instructions)
<u>01A01: Domestic / Single residence</u>	<u>01A01: Domestic / Single residence</u>
_____	_____
_____	_____

**7. Description**

<b>Architectural Classification</b> (Enter categories from instructions)	<b>Materials</b> (Enter categories from instructions)
<u>05D: Late Victorian/Queen Anne</u>	foundation <u>03 Brick</u>
_____	walls <u>03 Brick</u>
_____	roof <u>08A Asphalt Shingles</u>
_____	other _____

**Narrative Description** ( SEE CONTINUATION SHEETS, WHICH MUST BE COMPLETED)

**8. Statement of Significance**

**Applicable National Register Criteria** (Mark "x" representing your opinion of eligibility after applying relevant National Register criteria)

<input checked="" type="checkbox"/> Yes <input type="checkbox"/> No <input type="checkbox"/> More Research Recommended	A	Property is associated with significant events.
<input type="checkbox"/> Yes <input checked="" type="checkbox"/> No <input type="checkbox"/> More Research Recommended	B	Property is associated with the lives of significant persons.
<input type="checkbox"/> Yes <input checked="" type="checkbox"/> No <input type="checkbox"/> More Research Recommended	C	Property has distinctive architectural characteristics.
<input type="checkbox"/> Yes <input type="checkbox"/> No <input type="checkbox"/> More Research Recommended	D	Property yields significant information in archaeology or history.

County Muscatine Address 309 West 2<sup>nd</sup> Street Site Number 70-00170  
City Muscatine District Number 70-01005

**Criteria Considerations**

- A Owned by a religious institution or used for religious purposes.
- B Removed from its original location.
- C A birthplace or grave.
- D A cemetery
- E A reconstructed building, object, or structure.
- F A commemorative property.
- G Less than 50 years of age or achieved significance within the past 50 years.

**Areas of Significance** (Enter categories from instructions)

31: Other – Neighborhood Development

**Significant Dates**

Construction date 1891  check if circa or estimated date  
Other dates \_\_\_\_\_

**Significant Person**

(Complete if National Register Criterion B is marked above)

**Architect/Builder**

Architect \_\_\_\_\_  
Builder \_\_\_\_\_

**Narrative Statement of Significance**  SEE CONTINUATION SHEETS, WHICH MUST BE COMPLETED

**9. Major Bibliographical References**

Bibliography  See continuation sheet for citations of the books, articles, and other sources used in preparing this form

**10. Geographic Data**

**UTM References (OPTIONAL)**

Zone	Easting	Northing	Zone	Easting	Northing
1	_____	_____	2	_____	_____
3	_____	_____	4	_____	_____

See continuation sheet for additional UTM references or comments

**11. Form Prepared By**

name/title Rob Wilson, Volunteer; Devin Pettit, Volunteer (R.L. McCarley, consultant)  
organization Muscatine Historic Preservation Commission date April 26, 2006  
street & number 215 Sycamore telephone 563-264-1550  
city or town Muscatine state IA zip code 52761

**ADDITIONAL DOCUMENTATION (Submit the following items with the completed form)**

**FOR ALL PROPERTIES**

- Map:** showing the property's location in a town/city or township.
- Site plan:** showing position of buildings and structures on the site in relation to public road(s).
- Photographs:** representative black and white photos. If the photos are taken as part of a survey for which the Society is to be curator of the negatives or color slides, a photo/catalog sheet needs to be included with the negatives/slides and the following needs to be provided below on this particular inventory site:

Roll/slide sheet # _____	Frame/slot # _____	Date Taken _____
Roll/slide sheet # _____	Frame/slot # _____	Date Taken _____
Roll/slide sheet # _____	Frame/slot # _____	Date Taken _____

- See continuation sheet or attached **photo & slide catalog sheet** for list of photo roll or slide entries.
- Photos/illustrations without negatives are also in this site inventory file.

**FOR CERTAIN KINDS OF PROPERTIES, INCLUDE THE FOLLOWING AS WELL**

- Farmstead & District:** (List of structures and buildings, known or estimated year built, and contributing or non-contributing status)
- Barn:**
  - A sketch of the frame/truss configuration in the form of drawing a typical middle bent of the barn.
  - A photograph of the loft showing the frame configuration along one side.
  - A sketch floor plan of the interior space arrangements along with the barn's exterior dimensions in feet.

**State Historic Preservation Office (SHPO) Use Only Below This Line**

Concur with above survey opinion on National Register eligibility:  Yes  No  More Research Recommended  
 This is a locally designated property or part of a locally designated district.

Comments: \_\_\_\_\_

Evaluated by (name/title): \_\_\_\_\_ Date: \_\_\_\_\_

# Iowa Site Inventory Form Continuation Sheet

Page 3

Fulliam-Glass House  
Name of Property

Muscatine  
County

309 West 2<sup>nd</sup> Street  
Address

Muscatine  
City

## 7. Narrative Description

This is a two-story, two-bay Queen Anne style house. There are two original dominating wings. The front wing runs east-west and the rear wing runs north-south. At the rear, the east-west wing extends beyond (to the west) the north-south wing. The north side of the north-south wing terminates with bay windows while the south elevation of the north-south wing extends beyond the south elevation of the east-west wing and terminates with a gabled exterior wall and chimney. The brick chimney terminates with corbelled brick. The roof over the house is comprised of two steep gabled roofs which create a "+" in plan. The house has a variety of textures features to accent the architecture. The overall appearance of the house is bold. The interior has significant amount of original woodwork, which indicates its importance when constructed. This house is much more ornate and less utilitarian than other houses in this block. However, the attached photograph shows this house had even more detail in 1900. Unfortunately, some of the detail has been removed. The elements that have been removed include the decorative elements of the porches on both the first and second stories. An oriel window is not shown in this photograph but is shown in a circa 1914 photograph. The oriel window was located on the South elevation, where today you can see the newer brick and the newer series of three windows.

The south elevation (front), on the left-hand side, the first story has a pair of heavy ornate wood entry doors set into a small vestibule. These appear to be original to the house. On the exterior, pair of wood period appropriate screen doors provides entry into the vestibule. It is unknown if these doors are original. The doors are several risers above the front porch, which is several risers above the front grade. This series of steps to the entry gives the sense of importance and grandeur. This entry sequence is enhanced with the passage through the well-detailed vestibule. To the right of the entry doors is a small brick faced front porch. Above the porch are two narrow, one-over-one light, double hung windows. These windows have shallow arched brick heads. To the left of the entry doors is an oval window, which provides light into the ornate interior stairway. Above the vestibule and the front porch is a thin, flat, porch roof. It is supported by light steel vertical framework which is most likely not original to the house. At the second story and above and inline the first story windows is another pair of double-hung windows – matching the first story windows. To the left of these windows, the exterior wall projects out and is flush with the vestibule wall below. Within this wall are three, adjacent double-hung windows. Due to the obvious difference in the face brick, it is clearly apparent; this wall is not original and was added at a later date. Within the gable are boldly painted fish-scale shingles covering the entire gable from the eave to the top of the attic windows. The attic windows consist of three one-over-one, adjacent, double-hung windows. Within the triangular space, above the attic windows, is a finely detailed latticework.

The west elevation of the house is very close to 313. Between the front of the house and the north south wing are three double hung windows with shallow brick arches. Two of these windows provide light into the stairway and follow the slope of the stairway. The third window provides light into a second story bedroom. The brick arches are constructed with two rows of rowlock brick. The portion of the rear wing

# Iowa Site Inventory Form Continuation Sheet

Page 4

Fulliam-Glass House  
Name of Property

Muscatine  
County

309 West 2<sup>nd</sup> Street  
Address

Muscatine  
City

of the house that extends beyond the front wing has one window at each story facing east. These windows have the same characteristics as the adjacent windows.

The north elevation (rear) of the house is much less detail. This elevation has two double-hung windows at both the first and second floors and in line with each other. There is a small one-story flat roof wing tucked into the space between the east-west and north south wings on the south west side of the house. This small wing, according to the Sanborn Maps is not original and was added sometime after 1910 and before 1928. A door and a small double-hung window are on the west elevation of this addition.

The east elevation of the house has the bay window at about its mid-point. The façade of the bay window end is ornate. It has many of the details that are found on the front of the house. The windows occur at the first and second story and have the same characteristics that are found on all of the other windows. The bay window element terminates with a gable roof. The gable portion has the same fish scale shingles as is found on the front gable and has a pair of small double-hung windows. A pair of large eave brackets visually makes the transition from the angled bay window walls to the façade of the gabled end. On the north elevation of the wing and to the left of the of the north-south bay window wing, are two double-hung windows – one at each story. To the right of the bay window wing are three double-hung windows, two at the second story and one at the first story. There is a single rear entry door at the first story. Above the door and window is a small roof over the rear porch, which is tucked into the space between the wing and the wing on the northwest side of the house. A decorative wood column supports the porch roof.

There is no garage or carriage house on the property. However, a carriage house/stable was built at the same time as the main house as shown on the October 1892 Sanborn Map. The carriage house was brick with a gabled roof, a carriage opening, and four one-over-one double hung windows visible on the South elevation, as shown in a c. 1900 photograph.

## 8. Narrative Statement of Significance

The Fulliam-Glass House does not appear to be individually eligible for the National Register of Historic Places under Criteria B or C. It does appear to be potentially individually eligible for the National Register of Historic Places under Criterion A within the theme of Cultural and Ethnic Diversity. It also appears to be a contributing building in a potential “West Hill” neighborhood historic district.

The Fulliam-Glass House does not appear to be associated with any significant people. Dr. Fulliam, who was the first resident was a prominent doctor in Muscatine, but there were other significant doctors in Muscatine at the time. He was also mayor of Muscatine at a time of great progress, however many of these things were approved before he actually got in office (sewers, brick paving). This house also does not appear to be significant for its architecture. A number of features of this Queen Anne house have been removed, and there are better examples of this type of architecture in this potential district. Thus

# Iowa Site Inventory Form Continuation Sheet

Page 5

Fulliam-Glass House  
Name of Property

Muscatine  
County

309 West 2<sup>nd</sup> Street  
Address

Muscatine  
City

the Fulliam-Glass House does not appear to be individually eligible for the National Register of Historic Places under Criteria B and C.

It does however appear that the Fulliam-Glass House is potentially individually eligible for the National Register of Historic Places under Criterion A for its association with Cultural and Ethnic Diversity in Muscatine. The Glass family which moved into this house in 1915, and in which the last person in the family moved out in 1980, appear to be significant for their contributions to business, and their prominence among the Russian Jews that came to Muscatine in the early 20<sup>th</sup> century. They started two successful clothing stores in Muscatine. In August 1912, Abe Glass, one of the children of Sissman and Minnie Glass started the Chicago Lace store which later became the Bon Ton Store. In February 1914 Gertrude and Roy Glass; two other children of Sissman and Minnie Glass, started the Smart Shop, by 1927 the Glass Smart Shop. It was the Glass Smart Shop that was particularly prominent as it sold wedding gowns, and formal wear. In many years this was the only shop specifically listed as selling wedding gowns and formal wear. This business lasted a long time as well, closing down in 1992. There were a number of Russian Jews that came to Muscatine particularly between 1900 and 1910. While Russia was the birthplace of only 2.7% of foreign born households in 1900, it increased to 7% by 1910 (West Hill Survey report, McCarley). The Glass's came to America from Russia in 1884, according to the census; initially coming to New York, where the children were born. The Glass family appears to be one of the most successful of these families from Russia, at least financially. Besides the two businesses, they also owned the two houses immediately up hill from this house. They may have owned other real estate such as the buildings they had their businesses, but that needs to be researched further. Additional research needs to be conducted on the growing Russian population in this period to better assess the Glass family within this historic context.

The Fulliam-Glass House also appears to be a contributing building to a "West Hill" neighborhood historic district. This house shows fairly strong integrity although; this house probably has the least integrity among those on this side of the street in this block, with the removal of a number of decorative architectural details. This is one of eight houses on this side of the street that are all constructed of brick and show strong integrity. This block is an excellent example of 19<sup>th</sup> century neighborhood development. Thus it appears to be a contributing building to a potential "West Hill" neighborhood historic district.

The Fulliam-Glass House was built around 1891 by Dr. E.B. Fulliam, Sr. Before this house was built there was a tenement house as shown on the 1883 and 1888 Sanborn Maps, with the footprint of the current house on the 1892 Sanborn Map. E.B. Fulliam Sr. bought this property from Abraham Smalley on August 21, 1891 (Lots Book 22: 758). Dr. Fulliam is listed here in the city directory starting in 1893 and continuing thru 1904. He is listed as a physician and surgeon through this period with offices at 309 East 2<sup>nd</sup> Street. His wife Mary is listed here as well. In 1897-98 he is also listed as Mayor, although he was Mayor for a longer period than this. The 1900 census shows E.B. Fulliam (41) Mary (wife, 32), Hortence (daughter, 13), Gertrude (daughter, 10), Edmond Jr. (son, 8), and Anna Eichoff (servant, 24). E.B. Fulliam was born and attended schools in Muscatine until he went to Rush Medical School and Bennett Medical College, both in Chicago. He graduated from Bennett Medical College in 1879. He then moved back to Muscatine to practice medicine, in which he developed a large patronage. He was

# Iowa Site Inventory Form Continuation Sheet

Page 6

Fulliam-Glass House  
Name of Property

Muscatine  
County

309 West 2<sup>nd</sup> Street  
Address

Muscatine  
City

President of the company that brought the Muscatine North and South Railroad to Muscatine, as well as being President of Muscatine Light and Power Company. No dates are shown when he held these positions; however. He was mayor of Muscatine for five terms (1894, 1896-1900). His administration gave Muscatine its first brick paving and its first sewer pipe-both of which he was a strong proponent of. These things had already been approved of in January of 1894, and he did not take office until March. He was also a state representative for this area, a city health physician for two years, and a county health physician for one year. There is again no mention of when these occurred. He was also a pension examiner under President Cleveland. It is unknown exactly when this was either, but Cleveland was President (1885-89; 1893-97). He was also a member of many fraternal organizations and other medical groups (Richman 1911, v.2: 27-29). In 1904 a Karsien Tammenga a hostler and his wife Katie joined the Fulliam's at the house.

On September 28, 1905 Dr. Fulliam sold this property to Cornelius Toohey (Lot Books 38: 343). Mr. Toohey then sold to Andrew Healey on December 1, 1905 (38:510). The 1907 city directory shows W.E. Bliven living here. W.E. Bliven was reared in Columbus City and Conesville. In Muscatine he became connected with the clothing trade, but also had a financial stake in the Bliven and McKee Button Company, which started in 1895. In 1898, he moved to Takoma, Washington to be in the banking industry. In 1906 he returned to Muscatine where he became more involved in the button company. After his return Mr. Bliven became Vice-President of the Muscatine State Bank (Richman 1911, v.2: 118).

Sometime between 1905 and 1909, Titus Loan and Investment Company got this property, but so far it cannot be found when. Titus Loan and Investment sold the property to Ida Throop on April 6, 1909 (Lots Book 42: 5). The city directories show Frank and his wife Mabel, and Frank's brother George and his wife Ida, living here from the 1908-09 directory through the 1913 directory. Frank Throop was born and raised in New York. He came to Iowa with his father who became editor of the Mount Pleasant Free Press. Frank attended Iowa Wesleyan University in Mount Pleasant; graduating in 1879. It was while he was at college that he learned the printers trade, working initially in Clinton, Iowa for the *Clinton Herald* until September 1901, when he moved to Muscatine and became city editor of the *Muscatine Journal*. This job he continued until January 1903, when he went to Kewanee, Illinois to become editor and part owner of *Kewanee Evening Press*. In 1904 he went to Sterling, Illinois to become managing editor of *Sterling Standard*. In the Spring of 1905 he returned to Muscatine to become the managing editor of the *Muscatine Journal*, then after the death of W.L. Lane, became publisher in January 1907 (Richman 1911, v.2: 583-84). The city directories show Frank and his wife Mabel, and Frank's brother George and his wife Ida, living here from the 1908-09 directory through the 1913 directory. Frank Throop is listed as Secretary and general manager of Journal Printing in 1908-09, then as the Publisher of the *Muscatine Journal* in 1911, and in 1913 secretary and manager of the *Muscatine Journal*. George Throop is listed as the Deputy County Auditor during all of the years he lived here. The 1910 census shows George Throop (60, Deputy County Auditor at the courthouse), Lola Throop (53, wife of George), Frank (31, son of George, and Publisher of the city paper), Mabel Throop (30, wife of Frank), Marjorie (2, granddaughter), Clara Gimble (75, mother-in-law).

# Iowa Site Inventory Form Continuation Sheet

Page 7

---

Fulliam-Glass House	Muscatine
Name of Property	County
309 West 2 <sup>nd</sup> Street	Muscatine
Address	City

---

On November 4, 1915 Mina Glass bought this property from Ida Throop, George Throop, Frank Throop, and Mabel Throop. It not only included lot 4, but conveyed all rights to maintain the barn located two and one-half feet in lot five. The Glass family then proceeded to own this house until 1980, with the last entry for a Glass family in the city directories being 1979. In 1916 the city directory first list the Glass family as living in Muscatine. It also the first time that the Chicago Lace Store (later Bon Ton) is listed. The Smart Shop is not listed until 1919. This seems to contradict what the *Centennial Edition of the Muscatine Journal* says that the Chicago Lace store started in 1912, and the Smart Shop in 1914. The 1916 directory list: Sam Glass (Minnie)-Chicago Lace Store, Abe Glass-Chicago Lace Store, Pauline Glass-clk Chicago Lace Store, Sam Glass-Student. In 1919 city directory list: Sissman Glass(Minnie)-prop. Bon Ton and Smart Shop, Samuel-manager Smart Shop, Abraham-manager Bon Ton, Anna(Gertrude)-clk Smart Shop, Lawrence-dentist U.S. Army. The 1920 census shows Sissman Glass (55, retail merchant; millinery, Anna (54, wife-no job), Abram (27, son, manager millinery), Gertrude (23, daughter, saleslady-millinery), Lawrence (22, son, no job listed), Roy (20, son, salesman retail millinery), and Ruth (12, daughter-no job). The 1920 census indicates that Sissman and Minnie were Russian immigrants, while their children were born in New York from 1893 to 1906. The 1921 city directory lists: Sissman Glass (Minnie), proprietor Bon Ton millinery; A. Glass (Minnie), prop. Smart Shop?; Abraham Glass-manager Bon Ton millinery, Gertrude Glass-saleslady Smart Shop, Lawrence Glass-dentist, Ruth Glass-student M.H.S., and Roy Glass-manager Smart Shop. The 1923-24 directory lists: Sissman Glass(Minnie)-prop. Smart Shop, Gertrude Glass-saleslady New Smart Shop, Roy Glass-prop. New Smart Shop, Ruth Glass-Student M.H.S. Sissman Glass died on September 20, 1925. No obituary was found.

In 1927 the city directory lists Minnie-widow of Sissman, Gertrude Glass-clerk Smart Shop, Roy Glass manager Glass Smart Shop. In 1929 the city directory lists Minnie-widow of Sissman, Gertrude-clerk Glass Smart Shop, Roy Glass-Glass Smart Shop, Anna(Roy's wife)-Glass Smart Shop. From this point though the 1940-41 city directory the people and the occupations remain the same. From 1943 to 1949 just Minnie and Gertrude are listed as living here, with Gertrude continuing involved in the Glass Smart Shop.

The carriage house is mentioned during the years just after the death of Sissman Glass. The first mention is in 1927 with J.W. Garfield being here and working at Garfield Millinery. The rear is not mentioned again until 1936-37 when Ellerd Starkweather and his wife Hazel were living here, he was involved in auto repair. In 1938-39 George Snell was living here with his wife Luella, he is listed as a laborer. In 1940-41 Edward Miller and his wife Velma were living here, he is listed as being a bartender. The rear is listed as vacant from 1941 to 1943. In 1946 Ralph Lake lived here with his wife Mildred. The address is listed as 309 1/2 West 2<sup>nd</sup> Street. It is not known whether this was the carriage house or whether this was upstairs, however neither the rear or 309 1/2 is mentioned with this address again.

Pauline is mentioned in 1952 with her husband William J. Garfield in the carriage house. Interestingly this is just after the death of the mother Mina Glass on December 13, 1951. Pauline and Abe, both filed a complaint against their Sister Gertrude; who had inherited the whole estate of Mina excepting \$1 to each of the other children. Abe and Pauline claimed that Gertrude had made up the will when her mother was ill and not of sound mind. On September 20, 1954 both Abe and Pauline filed for dismissal of their

# Iowa Site Inventory Form Continuation Sheet

Site Number 70-00170

Related District Number 70-01005

Page 8

Fulliam-Glass House  
Name of Property

Muscatine  
County

309 West 2<sup>nd</sup> Street  
Address

Muscatine  
City

objections to the will without it being resolved (Abstract of Record). Anna "Gertrude" Glass was listed as being involved with the Glass Smart Shop thru the 1985 city directory; in later years she was helped out by her sister Ruth Polsky-Golder from 1952, until the business finally closed in 1992. As stated earlier Gertrude remained here until 1979, when she moved above the Glass Smart Shop store at 201 East 2<sup>nd</sup>.

## 9. Major Bibliographical References

Census Records, United States Census Bureau, 1920.

"Bon Ton" "Glass Smart Shop" Centennial Edition of the Muscatine Journal. May 31, 1940. pg. 99, 102.

City Directories, Muscatine. Various publishers, 1856-1993. Available as the Musser Public Library.

Deed/Abstract Records, Recorder's Office, Muscatine County Courthouse, Muscatine, Iowa.

Lewis, H.W. Picturesque Muscatine: a Booklet Descriptive of the "Pearl City" of Iowa. Muscatine, IA: H.W. Lewis pg.101.

Record Printing Company. Muscatine, Iowa. The Pearl City: Pearl Button Center of the World. Muscatine: Record Printing Company, c.1914.

Richman, Irving B. *History of Muscatine County, Iowa*. Chicago: S.J. Clarke Publishing Company, 1911.

Sanborn Map Company. "Muscatine, Iowa," Sanborn fire insurance maps. Pelham, NY: Sanborn Map Company, 1883, 1888, 1892, 1899, 1907, 1912, 1919, 1928. Accessed online at: Sanborn.umi.com.

Iowa Department of Cultural Affairs  
 State Historical Society of Iowa  
**Iowa Site Inventory Form**  
**Continuation Sheet**

Site Number 70-00170  
 Related District Number 70-01005

Page 9

Fulliam-Glass House  
 Name of Property

Muscatine  
 County

309 West 2<sup>nd</sup> Street  
 Address

Muscatine  
 City

**Location Map**



**Plans of buildings on site (from assessor's office)**

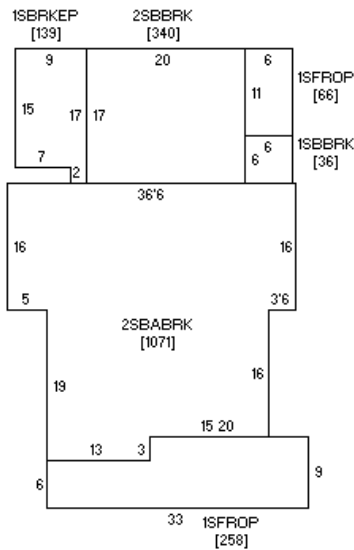

(front – W. 2<sup>nd</sup> Street)

# Iowa Site Inventory Form Continuation Sheet

Site Number 70-00170

Related District Number 70-01005

Page 10

---

Fulliam-Glass House  
Name of Property

Muscatine  
County

309 West 2<sup>nd</sup> Street  
Address

Muscatine  
City

---

## Photograph of building (digital image)

